

natuurreservaat
"de Oude Spoorwegberm"

4,580 km – 15,1569 ha

Biotopen

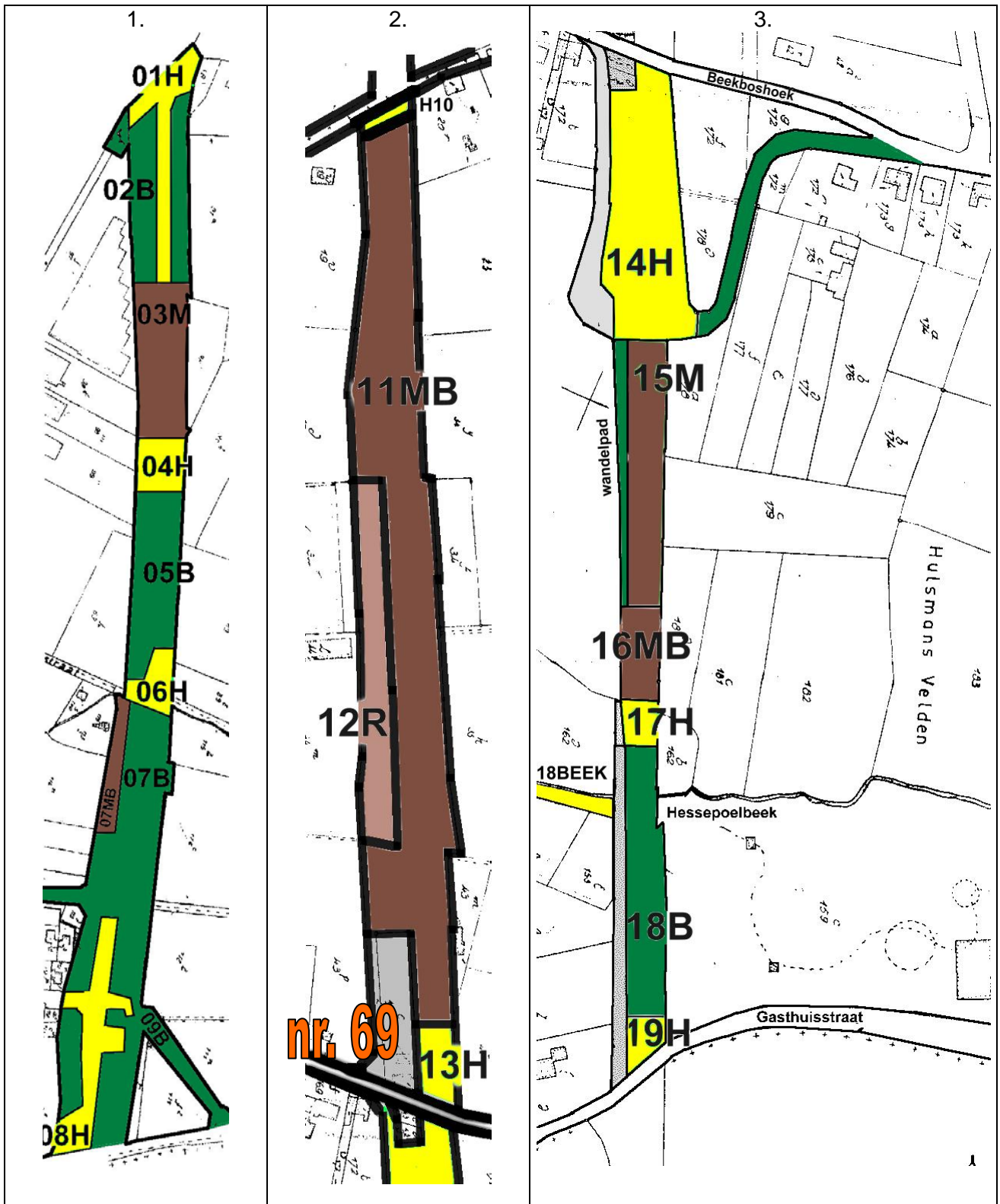

4,580 km – 15,1569 ha

Kontich	11,32 93 ha
Duffel	1,87 52 ha
Rumst	1,95 24 ha

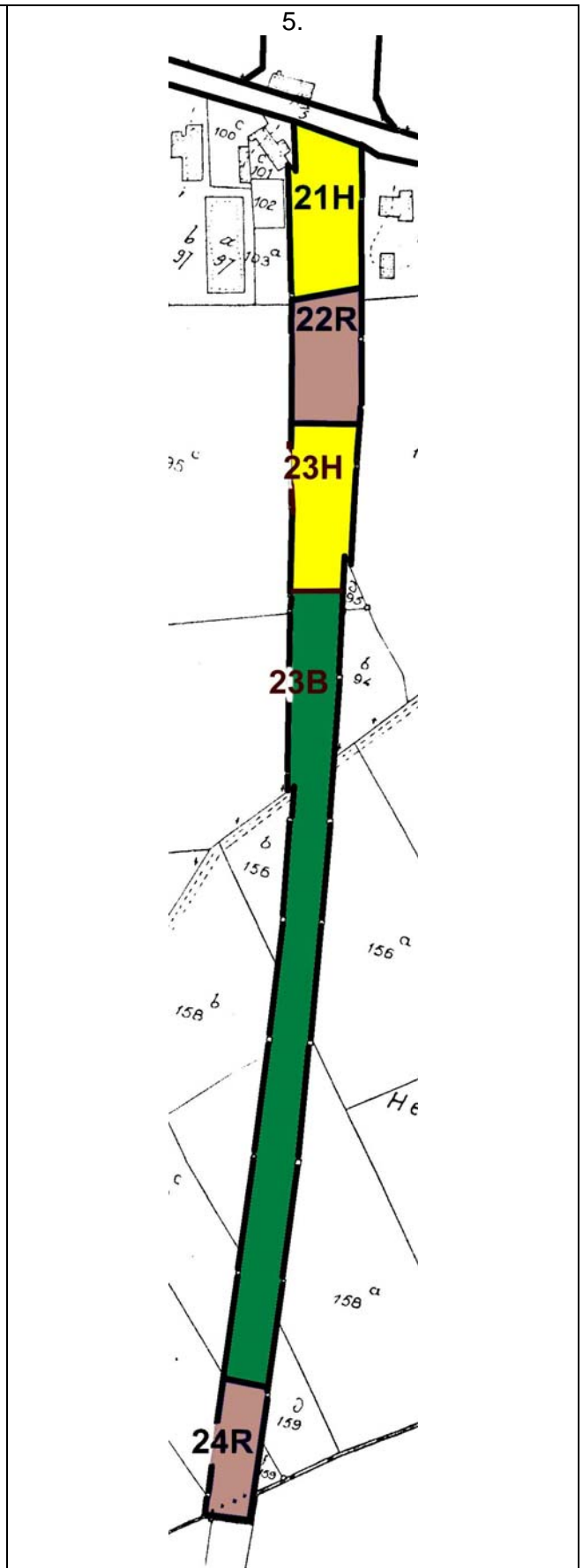
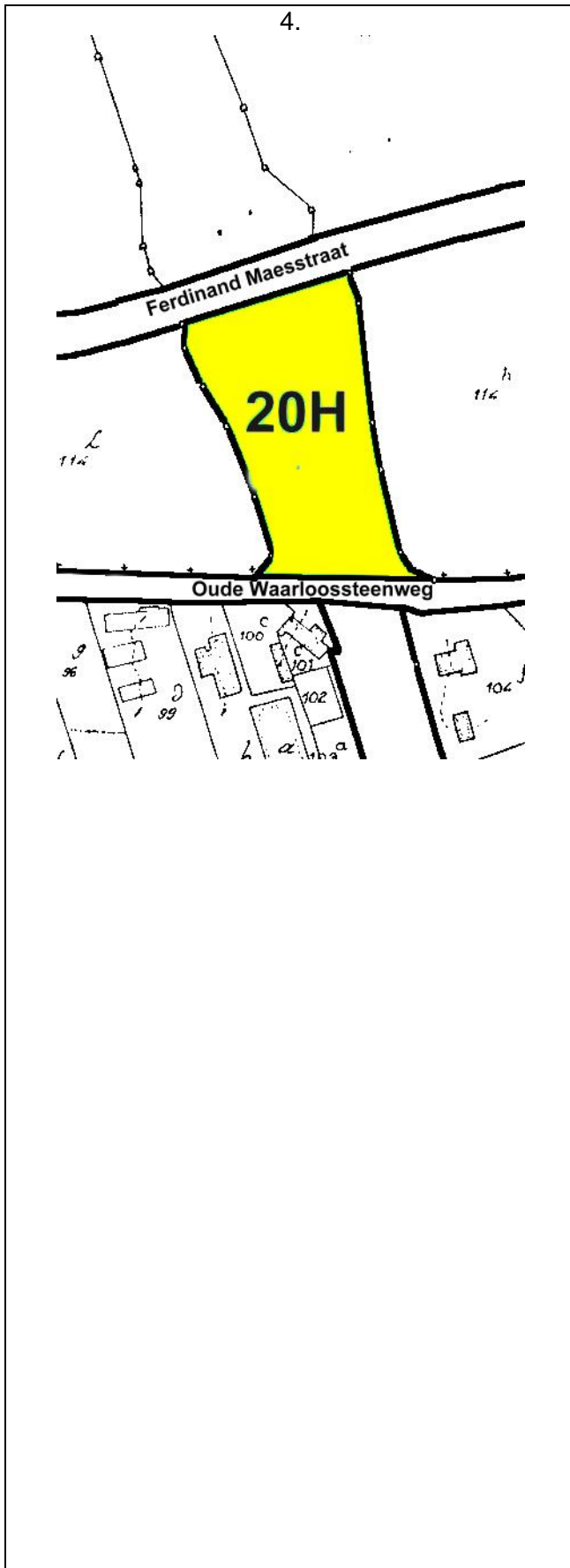

4,580 km – 15,1569 ha

6.

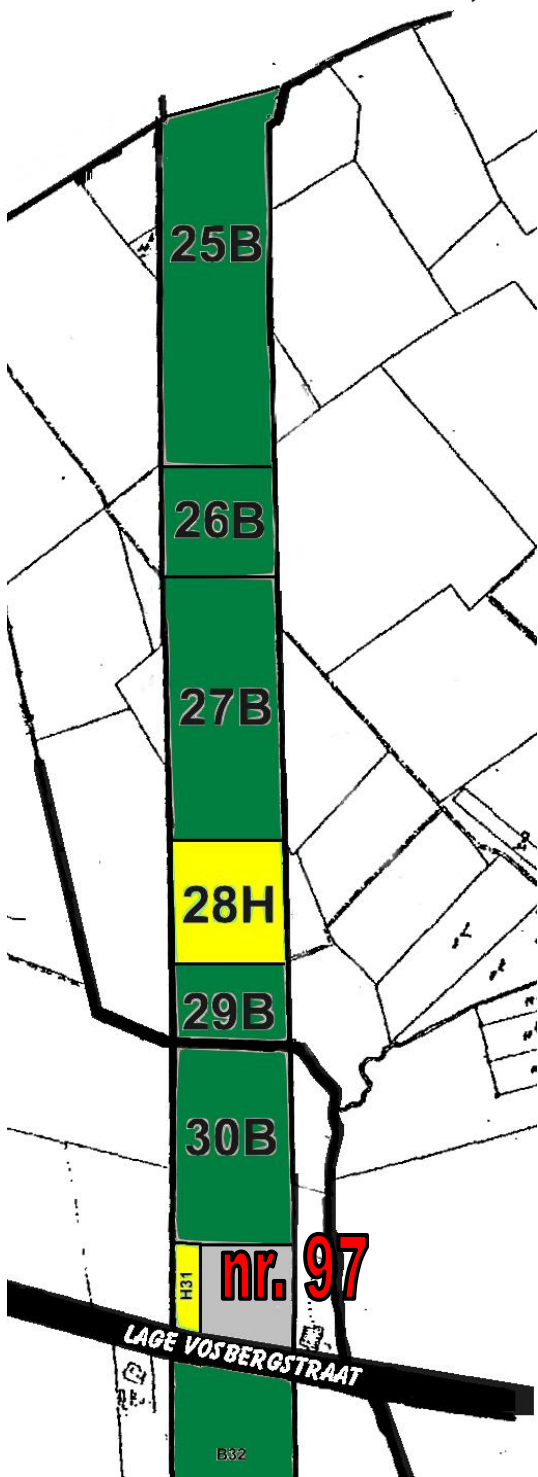

7.

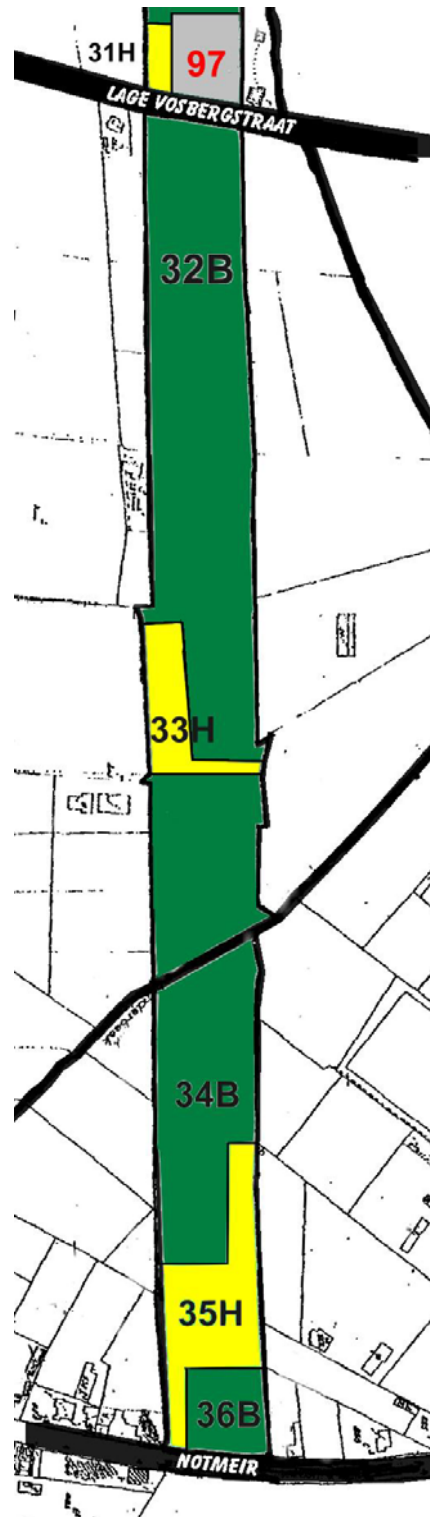

4,580 km – 15,1569 ha